

VICINITY MAP
NOT TO SCALE

SUGARLOAF REGIONAL AIRPORT CARRABASSETT VALLEY, MAINE

MASTER PLAN UPDATE

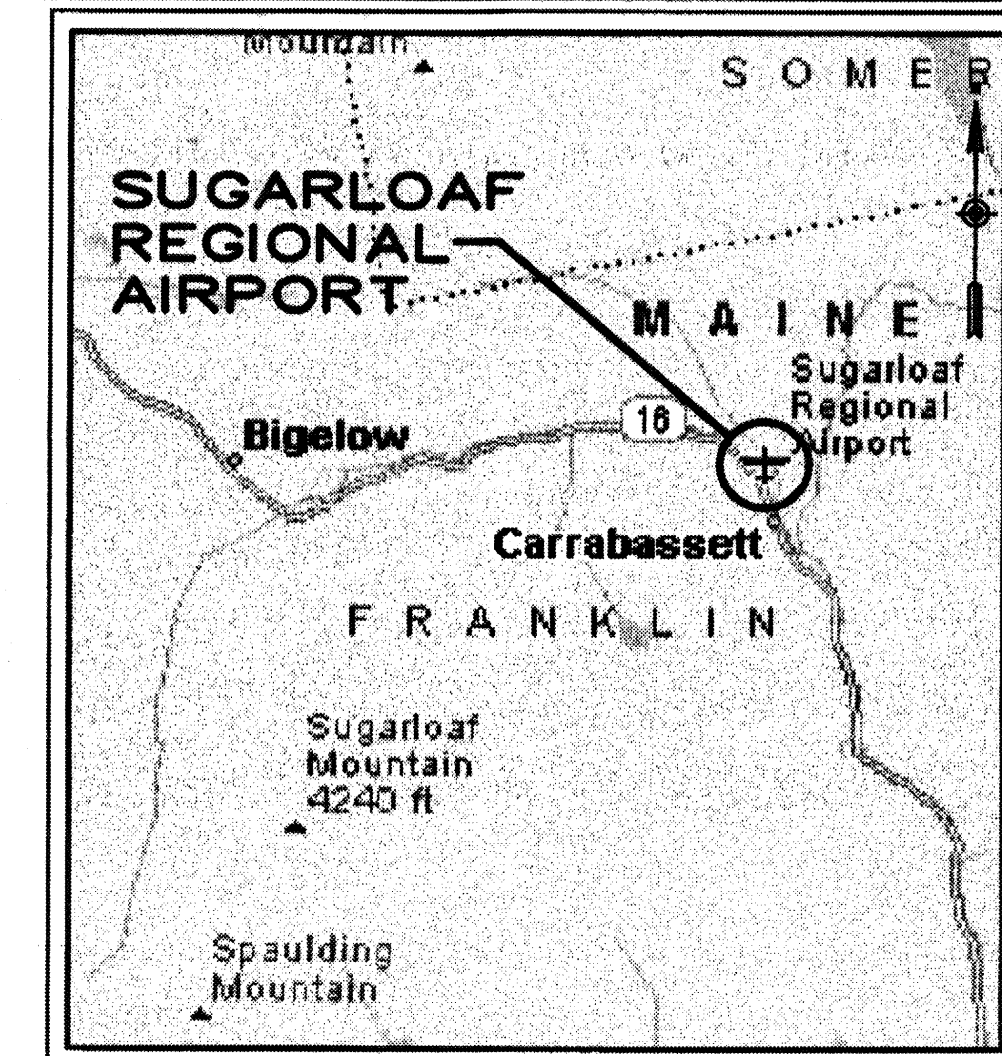

LOCATION MAP
NOT TO SCALE

MAINE DEPARTMENT OF TRANSPORTATION
STATE PROJECT NO. SAIP11.1010-02(14)
FEDERAL PROJECT NO. AIP3-23-2300-02

INDEX TO DRAWINGS

1. COVER/TITLE SHEET
2. ALP (EXISTING FACILITIES)
3. ALP (ULTIMATE FACILITIES)
4. FAR PART 77 AIRSPACE SURFACES

DECEMBER, 2003

| REV. NO. | DATE | BY | DESCRIPTION |
|----------|------|----|-------------|
| | | | |
| | | | |
| | | | |

| | |
|---------------------|--------------------|
| STATE PROJECT NO. | SAIP11.1010-02(14) |
| FEDERAL PROJECT NO. | AIP3-23-2300-02 |

| | |
|--|--|
| PROJECT DESIGNER | HTA Hoyle, Tanner & Associates, Inc. |
| 150 DOW STREET - MANCHESTER, NH 03101 - 1227 | DR. BY: TDB |
| TEL: (603) 669-5555 FAX: (603) 669-4166 | DES. BY: TLM |
| SCALE: AS SHOWN | DATE: DECEMBER, 2003 |
| | CHKD. BY: JRL |

| | |
|--|-------------------|
| SUGARLOAF REGIONAL AIRPORT AIRPORT MASTER PLAN | COVER/TITLE SHEET |
|--|-------------------|

| |
|--------------------------|
| HTA PROJ. No.: 302902.04 |
| Sg/CV01.dwg |
| DRAWING NO. |
| 1 |
| SHEET 1 OF 4 |

Carrabasset

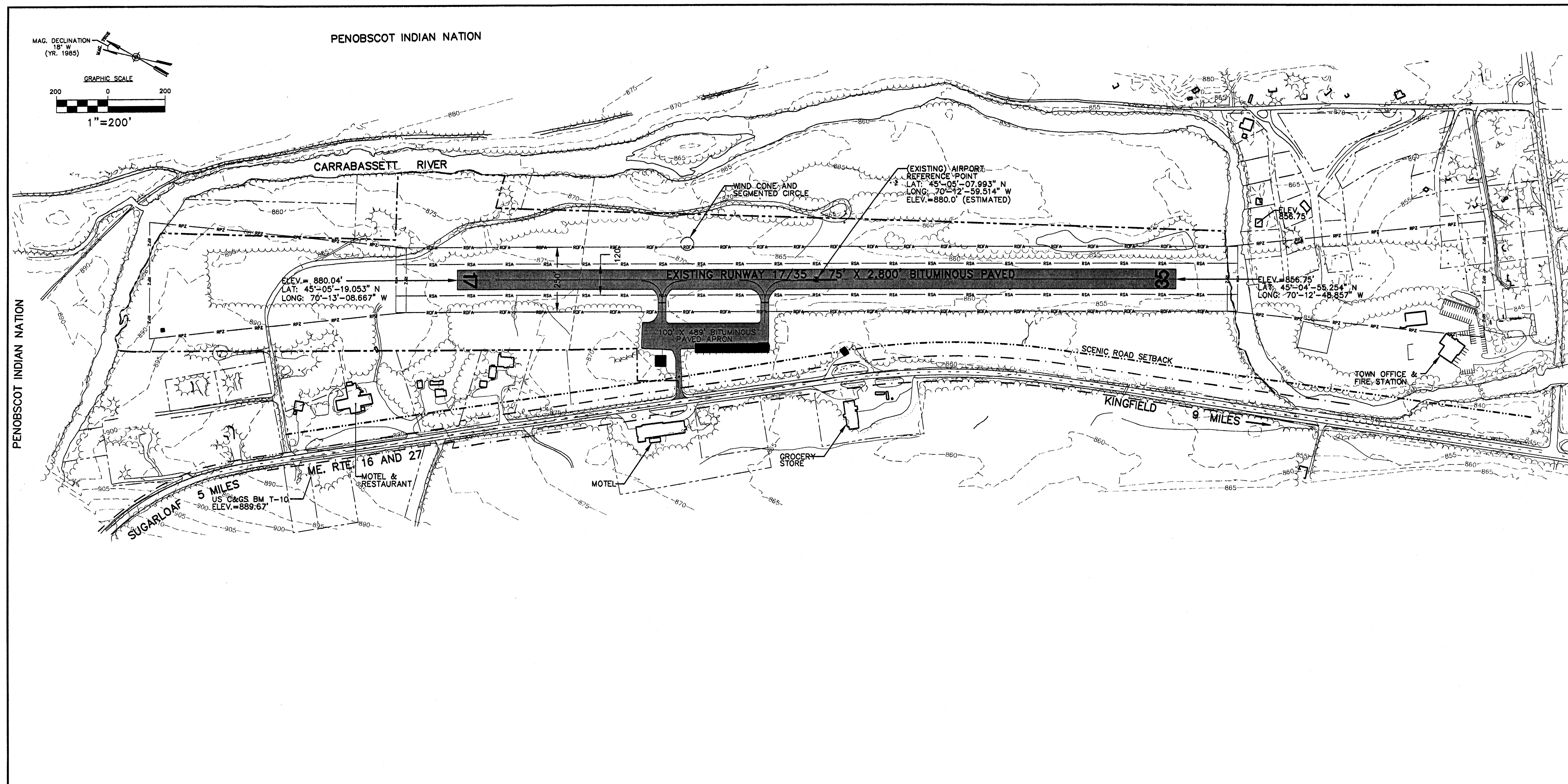

| REVISIONS | |
|-----------|-------------|
| REV. NO. | DESCRIPTION |
| | |
| | |
| | |

| | |
|---------------------|--|
| STATE PROJECT NO. | SAIP11-100-02(14) |
| FEDERAL PROJECT NO. | AF3-23-2300-02 |
| PROJECT DESIGNER | HFA Hoyle, Tanner & Associates, Inc. 150 DOW STREET - MANCHESTER, NH 03101-1227 Tel: (603) 689-5555 Fax: (603) 689-4188 WEB PAGE: www.hta-nh.com |
| DES. BY | TLM |
| DR. BY | TDB |
| CHKD. BY | JRL |
| SCALE: | AS SHOWN DATE: DECEMBER, 2003 |

| | |
|--|--|
| SUGARLOAF REGIONAL AIRPORT AIRPORT MASTER PLAN | AIRPORT LAYOUT PLAN (EXISTING FACILITIES) |
| HTA PROJ. No.: 302902.04 | Sgfaip02.dwg |
| DRAWING NO. | |
| 2 | |
| SHEET 2 OF 4 | |

| RUNWAY DATA | |
|------------------------|--|
| ITEM | EXISTING |
| RUNWAY PHYSICAL LENGTH | 2800' |
| RUNWAY WIDTH | 75' |
| STUB TAXIWAY WIDTH | 30' |
| PAVEMENT STRENGTH | 12,500 LBS. SINGLE WHEEL |
| PAVEMENT TYPE | ASPHALT |
| APPROACH TYPE | RWY 17: VISUAL RWY 35: VISUAL |
| APPROACH MINIMUMS | RWY 17: 3 MILES RWY 35: 3 MILES |
| APPROACH AIDS | WIND INDICATOR and SEGMENTED CIRCLE |
| AIRPORT CLASSIFICATION | UTILITY |
| RUNWAY LIGHTING | NONE |
| RUNWAY MARKING | RWY 17: VISUAL/BASIC RWY 35: VISUAL/BASIC |
| EFFECTIVE GRADIENT (%) | 0.0083% |
| TAXIWAY LIGHTING | NONE |
| RUNWAY END COORDINATES | RWY 17: Lat. 45005'19.053" / Long. -70013'08.667" RWY 35: Lat. 45004'55.254" / Long. -70012'48.857" |

| AIRPORT DATA | |
|---|--|
| ITEM | EXISTING |
| AIRPORT ELEVATION | 885' |
| AIRPORT REFERENCE POINT (ARP) | LAT. 45-05-10.199N LONG. 070-12-58.240W |
| MEAN MAX TEMPERATURE HOTTEST MONTH | 78.1°F |
| NAVIGATIONAL AIDS | WIND INDICATOR / SEGMENTED CIRCLE |
| DISTANCE FROM TOWN OF CARRABASSETT VALLEY | 1 MILE NORTH |
| LAND OWNED | 65 ACRES |
| AIRPORT AREA EASEMENTS | NONE KNOWN |
| OWNER | TOWN OF CARRABASSETT VALLEY, MAINE |
| MAG. DECLINATION - 1985 | 18W |
| CRITICAL AIRCRAFT WING SPAN | UP TO 49 FEET |
| CRITICAL AIRCRAFT APPROACH SPEED | LESS THAN 91 KNOTS |
| CRITICAL AIRCRAFT MTOW | UP TO 7,000 POUNDS |
| AIRPORT REFERENCE CODE | A-I, SMALL AIRCRAFT EXCLUSIVELY |

NOTE:
AIRPORT PROPERTY AND ABUTTING PROPERTY INFORMATION PROVIDED BY TOWN OF CARRABASSETT VALLEY TAX MAPS.

| LEGEND | | | |
|--------|--|-----------|---|
| SYMBOL | DESCRIPTION | SYMBOL | DESCRIPTION |
| — | PAVEMENT EDGE | - - - - | PREVIOUSLY ACQUIRED PROPERTY |
| — | RUNWAY PAVEMENT EDGE | - · - · - | SCENIC ROAD SET BACK |
| — | RUNWAY CENTERLINE | — | SEGMENTED CIRCLE / LIGHTED WINDSOCK (SEE CALLOUT) |
| — | EXISTING PAVEMENT | — | AIRPORT BEACON / UNLIGHTED WINDSOCK (SEE CALLOUT) |
| — | EXISTING TREE LINE | — | EXISTING TURF TIE DOWN |
| — | EXISTING CONTOUR (TYP) | — | RUNWAY PROTECTION ZONE |
| ■ | EXISTING BUILDING WITHIN AIRPORT PROPERTY | — | RUNWAY SAFETY AREA |
| □ | EXISTING BUILDING OUTSIDE AIRPORT PROPERTY | — | RUNWAY OBJECT FREE AREA |
| — | AIRPORT PROPERTY LINE | — | |
| — | ABUTTING PROPERTY LINES | — | |

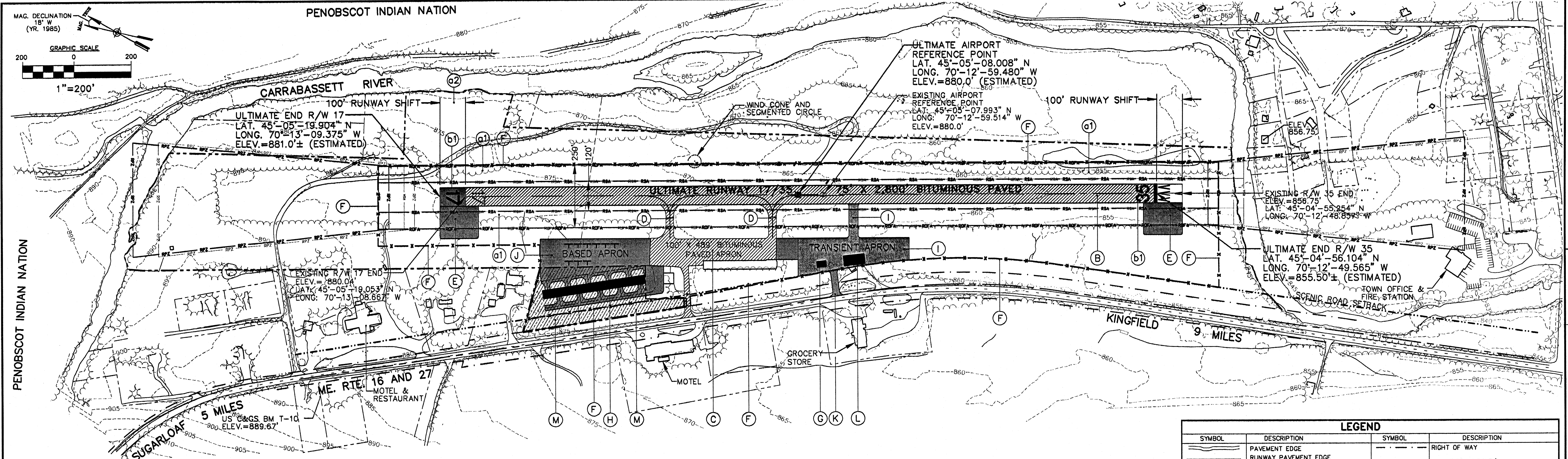

| | RUNWAY | APPROACH CATEGORY | APPROACH SLOPE |
|----------|--------|-------------------|----------------|
| FUTURE | 17 | VISUAL | SAME |
| | 35 | VISUAL | SAME |
| EXISTING | 17 | VISUAL | 0:1 |
| | 35 | VISUAL | 5:1 |

| | RUNWAY | APPROACH CATEGORY | LENGTH | INNER WIDTH | OUTER WIDTH |
|----------|--------|-------------------|--------|-------------|-------------|
| FUTURE | 17 | VISUAL | 1,000 | 250 | 450 |
| | 35 | VISUAL | 1,000 | 250 | 450 |
| EXISTING | 17 | VISUAL | 1,000 | 250 | 450 |
| | 35 | VISUAL | 1,000 | 250 | 450 |

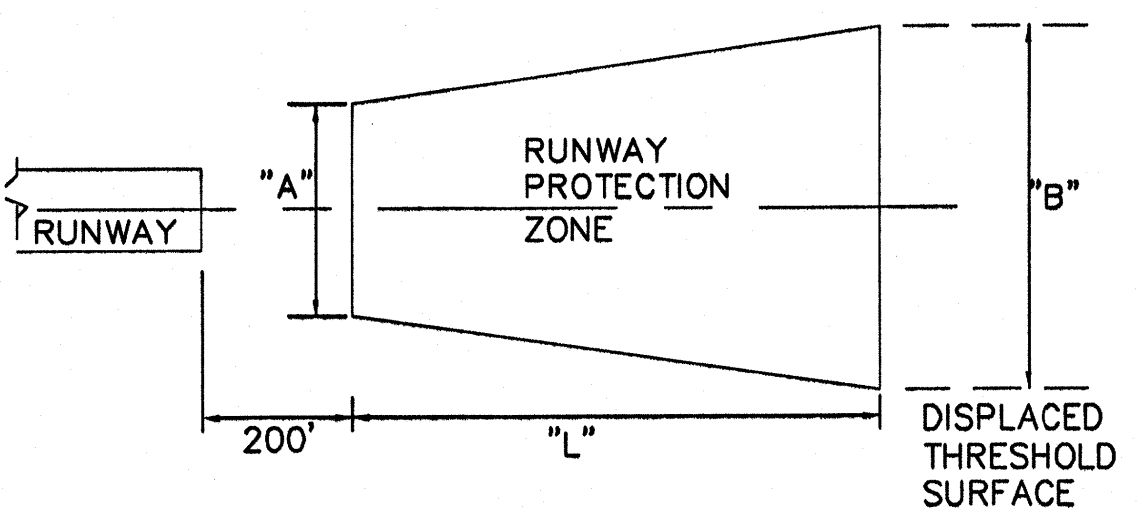

| ITEM | RUNWAY 17-35 | |
|------------------------|--|---|
| | EXISTING | ULTIMATE |
| RUNWAY PHYSICAL LENGTH | 2800' | 2900'-T/O Rwy 35, (100' Displ. Thshld. Rwy 35) |
| RUNWAY WIDTH | 75' | SAME |
| STUB TAXIWAY WIDTH | 30' | SAME |
| PAVEMENT STRENGTH | 12,500 LBS. SINGLE WHEEL | SAME |
| PAVEMENT TYPE | ASPHALT | SAME |
| APPROACH TYPE | Rwy 17: VISUAL Rwy 35: VISUAL | SAME |
| APPROACH MINIMUMS | Rwy 17: 3 MILES Rwy 35: 3 MILES | SAME |
| APPROACH AIDS | WIND INDICATOR and SEGMENTED CIRCLE | SAME |
| AIRPORT CLASSIFICATION | UTILITY | SAME |
| RUNWAY LIGHTING | NONE | MIRL |
| RUNWAY MARKING | Rwy 17: VISUAL/BASIC Rwy 35: VISUAL/BASIC | SAME |
| EFFECTIVE GRADIENT (%) | 0.0083% | SAME |
| TAXIWAY LIGHTING | NONE | MILT |
| RUNWAY END COORDINATES | Rwy 17: Lat. 45°05'19.053" N Long. -70°13'08.667" W Rwy 35: Lat. 45°04'55.254" N Long. -70°12'48.857" W | Rwy 17: Lat. 45°05'19.0904" N Long. -70°13'09.375" W Rwy 35: Lat. 45°04'56.104" N Long. -70°12'49.565" W |

| RUNWAY | LANDING | TAKEOFF |
|--------|---------|---------|
| 17 | 2800' | 2800' |
| 35 | 2800' | 2900' |

NOTE:
AIRPORT PROPERTY AND ABUTTING PROPERTY INFORMATION PROVIDED BY TOWN OF CARRABASSETT VALLEY TAX MAPS.

| DESIGN ELEMENT | DESIGN CRITERIA | RUNWAY 17-35 | | | |
|--|-----------------|--------------|--------|-----------|--------|
| | | RUNWAY 17 | | RUNWAY 35 | |
| | | EXISTING | FUTURE | EXISTING | FUTURE |
| RUNWAY SAFETY AREA (RSA) | | | | | |
| WIDTH | 120 | 120 | 120 | 120 | 120 |
| LENGTH BEYOND RUNWAY END | 240 | 240 | 240 | 240 | 240 |
| RUNWAY OBSTACLE FREE ZONE (ROFZ) | | | | | |
| WIDTH | 250 | 170 | 250 | 200 | 250 |
| LENGTH BEYOND RUNWAY END | 200 | 200 | 200 | 200 | 200 |
| RUNWAY OBSTACLE FREE AREA (ROFA) | | | | | |
| WIDTH | 250 | 170 | 250 | 200 | 250 |
| LENGTH BEYOND RUNWAY END | 240 | 240 | 240 | 240 | 240 |
| TAXIWAY | | | | | |
| WIDTH | 25 | 30 | 30 | 30 | 30 |
| TAXIWAY SAFETY AREA (TSA) WIDTH | 49 | 49 | 49 | 49 | 49 |
| TAXIWAY OBJECT FREE AREA (TOFA) WIDTH | 89 | 89 | 89 | 89 | 89 |
| RUNWAY SEPARATION STANDARDS | | | | | |
| RUNWAY CENTERLINE TO TAXIWAY/TAXILANE CENTERLINE | 150 | N/A | N/A | N/A | N/A |
| RUNWAY CENTERLINE TO AIRCRAFT PARKING AREA | 125 | 125 | 125 | 125 | 125 |
| TAXIWAY SEPARATION STANDARDS | | | | | |
| TAXIWAY CENTERLINE TO PARALLEL TAXIWAY/TAXILANE CENTERLINE | 69 | 69 | 69 | 69 | 69 |
| TAXIWAY CENTERLINE TO A FIXED OR MOVEABLE OBJECT | 44.5 | 44.5 | 44.5 | 44.5 | 44.5 |

| ITEM | EXISTING | ULTIMATE |
|---|--|-----------|
| AIRPORT ELEVATION | 885' | SAME |
| AIRPORT REFERENCE POINT (ARP) | LAT. 45-05-10.199N LONG. 070.12-58.240W | SAME |
| MEAN MAX TEMPERATURE HOTTEST MONTH | 78.1F | SAME |
| NAVIGATIONAL AIDS | WIND INDICATOR / SEGMENTED CIRCLE | SAME |
| DISTANCE FROM TOWN OF CARRABASSETT VALLEY | 1 MILE NORTH | SAME |
| LAND OWNED | 65 ACRES | SAME |
| AIRPORT AREA EASEMENTS | NONE KNOWN | SAME |
| OWNER | TOWN OF CARRABASSETT VALLEY, MAINE | SAME |
| MAG. DECLINATION - 1985 | 18W | VARIABLES |
| CRITICAL AIRCRAFT WING SPAN | UP TO 49 FEET | SAME |
| CRITICAL AIRCRAFT APPROACH SPEED | LESS THAN 91 KNOTS | SAME |
| CRITICAL AIRCRAFT MTOW | UP TO 7,000 POUNDS | SAME |
| AIRPORT REFERENCE CODE | A-1, SMALL AIRCRAFT EXCLUSIVELY | SAME |

| SYMBOL | DESCRIPTION | SYMBOL | DESCRIPTION |
|--------|---|--------|-------------------------------------|
| --- | PAVEMENT EDGE | --- | RIGHT OF WAY |
| --- | RUNWAY PAVEMENT EDGE | --- | SEGMENTED CIRCLE / LIGHTED WINDSOCK |
| --- | RUNWAY CENTERLINE | --- | (SEE CALLOUT) AIRPORT BEACON |
| --- | EXISTING PAVEMENT | --- | EXISTING TIE DOWN |
| --- | EXISTING PAVEMENT TO BE REPAVED | --- | PROPOSED TIE DOWN |
| --- | NEW PAVEMENT | --- | EXISTING PROTECTION ZONE |
| --- | PROPERTY ACQUISITION | --- | EXISTING RUNWAY SAFETY AREA |
| --- | EXISTING TREE LINE | --- | EXISTING RUNWAY OBJECT FREE AREA |
| --- | EXISTING CONTOUR (TYP) | --- | ULTIMATE PROTECTION ZONE |
| --- | PROPOSED BUILDING WITHIN AIRPORT PROPERTY | --- | ULTIMATE RUNWAY SAFETY AREA |
| --- | EXISTING BUILDING | --- | ULTIMATE RUNWAY OBJECT FREE AREA |
| --- | AIRPORT PROPERTY LINE | --- | |
| --- | PARCEL LINE | --- | |
| --- | PREVIOUSLY ACQUIRED PROPERTY | --- | |
| --- | SCENIC ROAD SETBACK | --- | |

| | |
|----|--|
| A | Safety Area Improvements: |
| a1 | Clear Runway 17-35's Object Free Zone (OFZ) and Object Free Area (OFA) of Obstructing Trees/Shrubs |
| a2 | Shift Runway to the North to Recapture Runway Safety Area at Runway End 35 |
| a3 | Keep pavement from runway shift for use as a displaced threshold |
| B | Overlay Runway 17-35 |
| b1 | Repaint Basic Pavement Markings |
| C | Overlay Existing Apron |
| D | Crack Seal Two Existing Stub Taxiways |
| E | Construct Holding Areas at The Approach Ends of Runway 17-35 |
| F | Install Wildlife/Security Fencing Around Aircraft Movement Area |
| G | Install Self-Service Fuel Station |
| H | Construct a 10-Unit T-Hangar |
| I | Construct Transient Apron and Tie-Down Spaces / New Stub Taxiway |
| J | Construct Additional Based Tie-Down Spaces / Relocate Existing Tie-Down Spaces |
| K | Construct New Airport Entrance |
| L | Construct New Multi-Purpose Building |
| M | Acquire lots 30-1 and 30-2 |

| Description |
|--|
| 1 Existing road is located within runway end 17's OFA, OFZ and RPZ. |
| 2 Significant penetrations into FAR Part 77 Surfaces by surrounding terrain. |
| 3 Aircraft parked in existing tie-down spaces penetrate FAR Part 77 Transitional Surface Slope of 7:1. |

| | | |
|---|---|------------------------------|
| FEDERAL AVIATION ADMINISTRATION NEW ENGLAND REGION AIRPORT DIVISION | MAINE DEPARTMENT OF TRANSPORTATION OFFICE OF PASSENGER TRANSPORTATION | TOWN OF CARRABASSETT VALLEY |
| APPROVED: <i>[Signature]</i> | APPROVED: <i>[Signature]</i> | APPROVED: <i>[Signature]</i> |
| DATE: 2-30-2007 | DATE: 9-8-07 | DATE: 7/26/09 |

| | |
|---------------------|--|
| STATE PROJECT NO. | SAF11-1010-02(14) |
| FEDERAL PROJECT NO. | AP3-23-2300-02 |
| PROJECT DESIGNER | Hoyle, Tanner & Associates, Inc. |
| PROJECT NO. | 150 DOW STREET - MANCHESTER, NH 03101 - 1227 |
| DATE | DEC 2003 |
| REVISIONS | BY: JRL |
| DATE | DR. BY: TDB |
| NO. | DES. BY: KRS |
| BY | SCALE: AS SHOWN DATE: DECEMBER, 2003 |
| DESCRIPTION | SUGARLOAF REGIONAL AIRPORT AIRPORT MASTER PLAN |
| | AIRPORT LAYOUT PLAN (ULTIMATE FACILITIES) |
| | DRAWING NO. 3 |
| | SHEET 3 OF 4 |

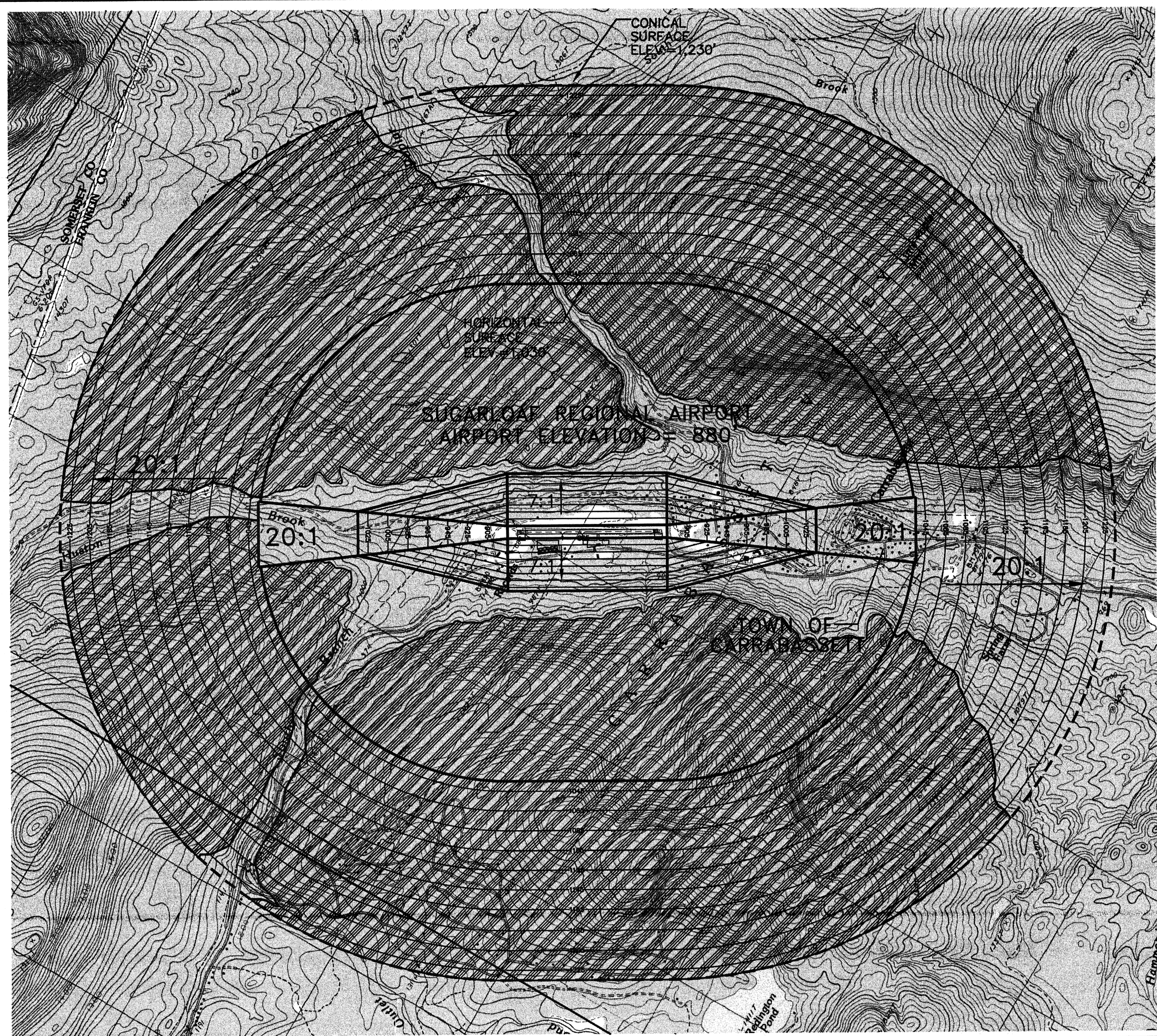
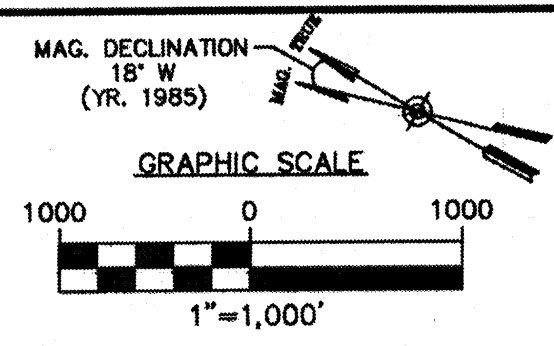

| Part 77 Airspace Surfaces | | |
|---------------------------|-----------|-----------|
| Airport Data | Runway 17 | Runway 35 |
| Classification | Utility | Utility |
| Approach | Visual | Visual |
| Visibility Minimums | 3 miles | 3 miles |
| Airport Elevation | 880' | *885' |
| Airport Imaginary Surface | Runway 17 | Runway 35 |
| Horizontal Surface: | | |
| Elevation | 1,030 | 1,030 |
| Radius | 5,000 | 5,000 |
| Conical Surface: | | |
| Horizontal Distance | 4,000 | 4,000 |
| Slope | 20:1 | 20:1 |
| Primary Surface: | | |
| Length Beyond Runway End | 200 | 200 |
| Width | 250 | 250 |
| Approach Surface: | | |
| Horizontal Distance | 5,000 | 5,000 |
| Inner Edge Width | 250 | 250 |
| Outer Edge Width | 1,250 | 1,250 |
| Slope | 20:1 | 20:1 |
| Transitional Surfaces: | | |
| Slope | 7:1 | 7:1 |

Source: FAR Part 77, Objects Affecting Navigable Airspace

Note: Dimensions are in feet unless otherwise noted.

* 885' is listed as estimated airport elevation from Air-nav. 880' elevation used is based on data provided from Maine D.O.T.

| LEGEND | | | |
|--------|---------------------------|--------|--|
| SYMBOL | DESCRIPTION | SYMBOL | DESCRIPTION |
| | EXISTING ROADS | | APPROACH SURFACE ABOVE HORIZONTAL SURFACE ELEVATION |
| | EXISTING DIRT/4WD ROAD | | APPROACH SURFACE |
| | CONICAL SURFACE | | GROUND SURFACE PENETRATING THROUGH FARPART 77 IMAGINARY SURFACES |
| | HORIZONTAL SURFACE | | |
| | SURFACE ELEVATION CONTOUR | | |

| REVISIONS | |
|-----------|-------------|
| REV. NO. | DESCRIPTION |
| 1 | |

STATE PROJECT NO. SAH11.1010-02(14)

FEDERAL PROJECT NO. AP3-23-2300-02

PROJECT DESIGNER
Hoyle, Tanner & Associates, Inc.
150 DOW STREET - MANCHESTER, NH 03101 - 1227
Tel: (603) 669-5555 Fax: (603) 669-4168 WEB PAGE: www.hta-nh.com

DES. BY TLM
DR. BY TDB
CHKD. BY JRL

SCALE: AS SHOWN DATE: DECEMBER, 2003

SUGARLOAF REGIONAL AIRPORT AIRPORT MASTER PLAN

FAR PART 77 AIRSPACE SURFACES

HTA PROJ. No.: 302902.04
SgIP77.dwg

DRAWING NO. **4**

SHEET 4 OF 4